



Suture Materials for the A&E Department

REPAIR & REGENERATE



Advanced Medical Solutions

Suture Materials for the A&E Department

Optimally designed range of surgical sutures for the treatment of skin wounds in the A&E department.

Requirement: A clinician needs a highly reliable, convenient tool made of high quality materials.

Applications:

- ▶ Standard simple interrupted sutures or mattress sutures
- ▶ Non-absorbable continuous and/or intracutaneous sutures
- ▶ Continuous and intracutaneous sutures for all absorption profiles
- ▶ Small and standardised portfolios

- ✔ Reduced tissue trauma due to minimised needle diameter
- ✔ Sustainable sharpness due to improved silicone application
- ✔ Improved skin penetration due to optimised cutting edges
- ✔ Fine gradation of needle sizes

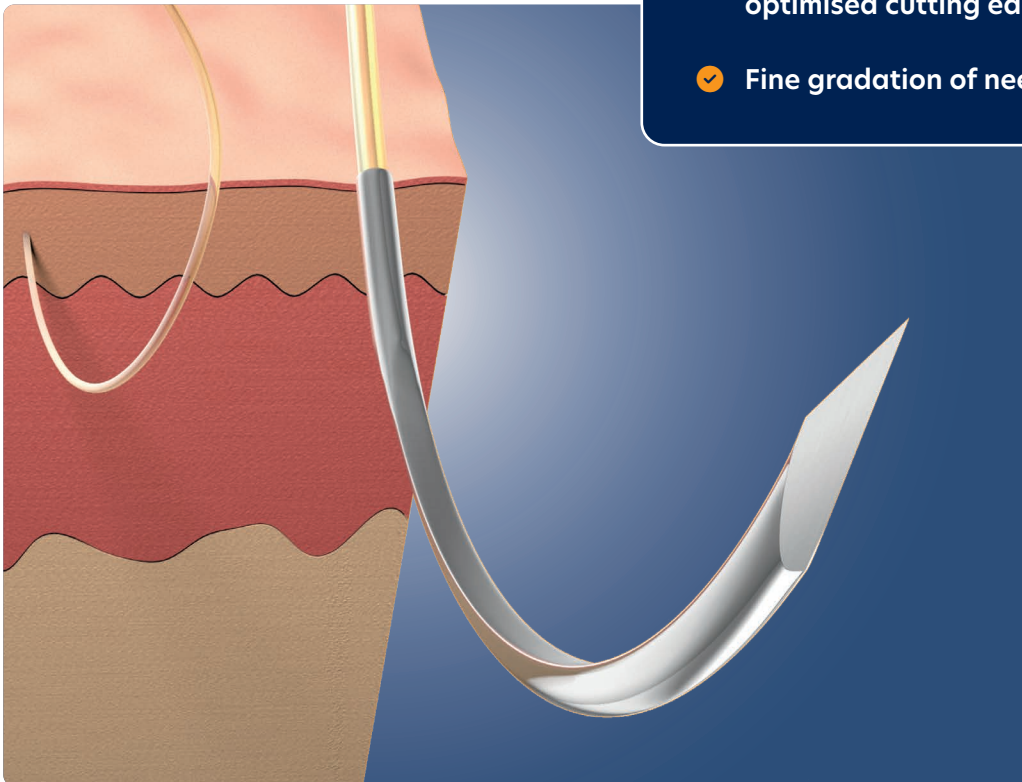

An unimpeded healing process after procedures in the A&E department is crucial for good functional and aesthetic result.

Modern suturing materials ensure the best possible care for every kind of wounds. Different needle geometries guarantee best care, even in areas that are difficult to access. In our research and development department, first-class handling properties and the highest degree of patient comfort are our top priorities.

GLYCOLON®

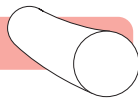

The production of GLYCOLON® involves the copolymerisation of polyglycolic acid and ϵ -caprolactone in a certain ratio. The breakdown of the polymeric suture in the tissue occurs through water uptake, thereby reversing the synthesis. The strength of GLYCOLON® reduces to 30 % after 7 days. The completely safe intermediary products that are formed, as well as the smooth, monofilament surface structure of the thread, result in minimal tissue reaction. The smooth, monofilament surface structures of the polymer give GLYCOLON® excellent handling and tissue passage properties. Tissue trauma as a result of suturing is not relevant to GLYCOLON®, and the monofilament structure prevents wicking of the thread without the need for additional surface treatment. GLYCOLON® is available undyed, especially suitable for skin closure, and in violet (coloured with the physiologically harmless D+C No. 2 dye).

Polyester

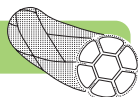

POLYESTER is produced by polycondensation of ethylene glycol and terephthalic acid. Fibres are formed using the dry spinning process. Precisionbraiding and tempering transform the stretched, slightly twisted fibre bundles into a suture. The individual fibres are hydrophobic, i.e., they repel water. The material is coloured with a physiologically harmless dye.

PGA RESORBA®

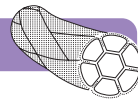

PGA RESORBA® is a polymer of glycolic acid. The linear, high molecular weight polyglycolic acid is synthesised in the presence of a catalyst via the intermediary product glycolide, a cyclic ester. The breakdown of the PGA suture in the tissue occurs through water uptake, thereby reversing the synthesis. Regular metabolic processes break down the glycolic acid monomers into CO_2 and H_2O through enzymatic degradation. The physical and physiological properties of suture material containing 10 % lactide as copolymer differ only slightly from pure PGA sutures.

The thin, precision-braided filaments provide very high tear resistance as well as excellent suppleness. The special coating thinly encapsulates the fibre bundles resulting in a specific reduction of surface friction. Absorbable sutures approximate the tissue during the healing phase; at the same time, they increasingly lose their tensile strength and tear resistance. PGA RESORBA® contains precisionbraided filaments made of polyglycolic acid that result in a standardised, moderate rate of absorption in the tissue. Depending on the thread diameter 50 % of the original tensile strength of PGA RESORBA® is lost after 18 days.*

Violet PGA RESORBA® is coloured with a physiologically harmless dye.

* Articles manufactured by Healthium experience a loss of strength of up to 56 % after 21 days

RESOPREN®

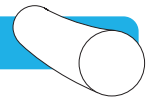

RESOPREN® is a blue, monofilament, synthetic suture made of polyvinylidene difluoride (PVDF). The suture is produced from the dyed granules using the dry spinning process. RESOPREN® is chemically inert, hydrophobic and highly resistant to ageing. Due to its chemical properties, its high tear strength and its good knotting properties, RESOPREN® is particularly suitable for use in non-absorbable intracutaneous sutures. The material is coloured with a physiologically harmless dye.

RESOLON®

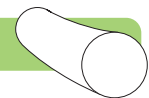

RESOLON® is a monofilament polyamide 6-6.6 suture. It undergoes special treatment during the manufacturing process. RESOLON® is exceptionally soft and supple even when dry and sterile. This ensures excellent handling and knotting properties, combined with optimal knot-pull strength for a monofilament thread, making RESOLON® the preferred choice for percutaneous single interrupted sutures. The material is coloured with a physiologically harmless dye.

Peel-eco-Pack:

A combination of peelable outer sachet and multifunctional inner sachet

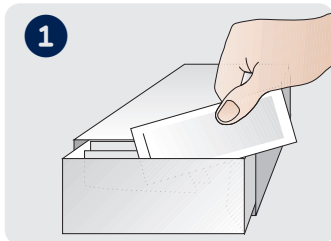

1 The peel-pack is removed from the storage box.

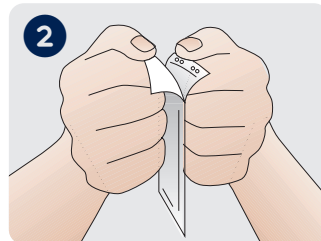

2 The Circulating Nurse grasps the two opening flaps at the upper end of the pack and opens it by evenly peeling the flaps apart.



3 The sterile contents are handed over without contamination.

4 Handling of the primary packets:

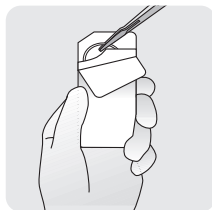

Single pack / needle-thread combination
Precut single sterile sutures with an attached surgical needle. The needle is exposed by turning over the perforated flap. It is then removed with a needle holder.

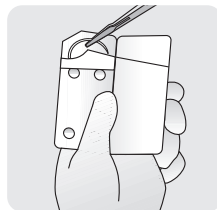

Single pack / needle-thread combination
The needle is exposed by folding out the suture carrier and then withdrawn with the needle holder.

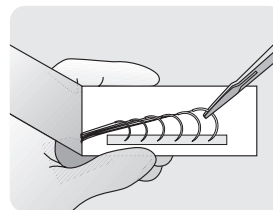

Multipack
Several combinations in each sterile primary packet. This simplifies the organisation of handing over the same thread combinations during standardised procedures. The needles are exposed by opening the side of the paper cover, after which the individual needles (one after the other) are taken out with the needle holder.

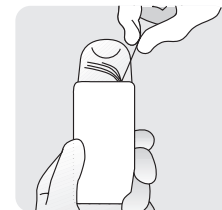

Precut sutures
One or more threads in each sterile primary packet. The suture is meant for ligatures or for use with eyed needles. After the upper flap has been opened, the individual threads can be withdrawn in any desired order.

Instructions

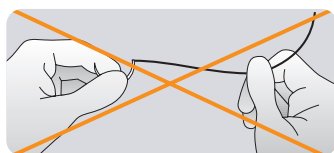

Stretching the thread
The thread must be stretched gently after it has been removed from the primary packet. Do not pull or rub it abruptly. Do not grasp the needle and stretch the thread!

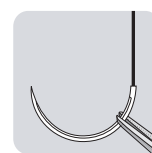
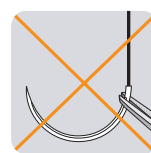
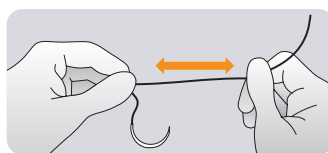

Holding the needle
Needles should be held approx. 3/4 away from the tip. Do not clamp where the suture is swaged to the needle to avoid weakening the needle and suture.

Products	REF	Description	Content
GLYCOLON®			
GLYCOLON® DSM 11	PB41502	Colour: undyed, Thread size: 6-0, monofilament Thread length: 45 cm	24 Pc.
GLYCOLON® DSM 13	PB41504	Colour: undyed, Thread size: 6-0, monofilament Thread length: 45 cm	24 Pc.
GLYCOLON® DSM 13	PB41505	Colour: undyed, Thread size: 5-0, monofilament Thread length: 45 cm	24 Pc.
GLYCOLON® DSM 13	PB41506	Colour: undyed, Thread size: 4-0, monofilament Thread length: 45 cm	24 Pc.
GLYCOLON® DSM 16	PB41524	Colour: undyed, Thread size: 5-0, monofilament Thread length: 45 cm	24 Pc.
GLYCOLON® DSM 16	PB41510	Colour: undyed, Thread size: 4-0, monofilament Thread length: 45 cm	24 Pc.
GLYCOLON® DSM 18	PB41526	Colour: undyed, Thread size: 3-0, monofilament Thread length: 70 cm	24 Pc.
GLYCOLON® DSM 24	PB41520	Colour: undyed, Thread size: 3-0, monofilament Thread length: 70 cm	24 Pc.
PGA RESORBA®			
PGA RESORBA® DSM 13	PAN1151 ¹⁾	Colour: undyed, Thread size: 5-0, multifilament Thread length: 45 cm	24 Pc.
PGA RESORBA® DSM 18	PAN1154 ¹⁾	Colour: undyed, Thread size: 4-0, multifilament Thread length: 45 cm	24 Pc.
PGA RESORBA® DSM 24	PA11519	Colour: undyed, Thread size: 3-0, multifilament Thread length: 70 cm	24 Pc.
PGA RESORBA® HR 17	PA1025	Colour: violet, Thread size: 4-0, multifilament Thread length: 70 cm	24 Pc.
PGA RESORBA® HR 22	PA10211	Colour: violet, Thread size: 3-0, multifilament Thread length: 70 cm	24 Pc.
RESOPREN®			
RESOPREN® DSM 11	771520	Colour: blue, Thread size: 6-0, monofilament Thread length: 45 cm	36 Pc.
RESOPREN® DSM 13	771526	Colour: blue, Thread size: 6-0, monofilament Thread length: 45 cm	36 Pc.
RESOPREN® DSM 13	771517	Colour: blue, Thread size: 5-0, monofilament Thread length: 45 cm	36 Pc.
RESOPREN® DSM 16	771525	Colour: blue, Thread size: 5-0, monofilament Thread length: 45 cm	36 Pc.
RESOPREN® DSM 16	77151	Colour: blue, Thread size: 4-0, monofilament Thread length: 45 cm	36 Pc.
RESOPREN® DSM 18	771529	Colour: blue, Thread size: 4-0, monofilament Thread length: 75 cm	36 Pc.
RESOPREN® DSM 18	77154	Colour: blue, Thread size: 3-0, monofilament Thread length: 45 cm	36 Pc.
RESOPREN® DSM 24	77159	Colour: blue, Thread size: 3-0, monofilament Thread length: 75 cm	36 Pc.
RESOPREN® DSM 30	771513	Colour: blue, Thread size: 3-0, monofilament Thread length: 75 cm	36 Pc.
RESOPREN® DSM 30	771514	Colour: blue, Thread size: 2-0, monofilament Thread length: 75 cm	36 Pc.
RESOLON®			
RESOLON® DSM 13	88154	Colour: blue, Thread size: 5-0, monofilament Thread length: 45 cm	36 Pc.
RESOLON® DSM 16	88155	Colour: blue, Thread size: 5-0, monofilament Thread length: 45 cm	36 Pc.
RESOLON® DSM 18	88159	Colour: blue, Thread size: 4-0, monofilament Thread length: 75 cm	36 Pc.
RESOLON® DSM 18	88158	Colour: blue, Thread size: 4-0, monofilament Thread length: 45 cm	36 Pc.
RESOLON® DSM 24	881518	Colour: blue, Thread size: 3-0, monofilament Thread length: 45 cm	36 Pc.
RESOLON® DS 13	881431	Colour: blue, Thread size: 5-0, monofilament Thread length: 45 cm	36 Pc.
RESOLON® DS 18	88144	Colour: blue, Thread size: 4-0, monofilament Thread length: 45 cm	36 Pc.
RESOLON® DS 18	88146	Colour: blue, Thread size: 3-0, monofilament Thread length: 45 cm	36 Pc.
RESOLON® DS 21	881411	Colour: blue, Thread size: 3-0, monofilament Thread length: 45 cm	36 Pc.
POLYESTER			
POLYESTER HS 22	81110	Colour: green, Thread size: 3-0, multifilament Thread length: 75 cm	36 Pc.
POLYESTER GS 60	8173	Colour: green, Thread size: 2-0, multifilament Thread length: 75 cm	36 Pc.

¹⁾ Product manufactured by:



RESORBA Medical GmbH

Am Flachmoor 16, 90475 Nürnberg, Germany

resorba.com | infomail@resorba.com | [+49 9128 / 91 15 0](tel:+49912891150)



Advanced Medical Solutions