

Suture Materials for Dermatology

REPAIR & REGENERATE



Advanced Medical Solutions

Optimally designed range of surgical sutures for the treatment of skin wounds in dermatological practice.

Requirement: For daily work in dermatological surgery, a precise, reliable, and well-structured portfolio is essential.

Applications:

- ▶ Standard single button sutures
- ▶ Non-absorbable continuous and/or intracutaneous sutures
- ▶ Continuous and intracutaneous sutures with various absorption profiles
- ▶ Compact and standardised portfolios

- ✔ Reduced tissue trauma due to minimised needle diameter
- ✔ Sustainable sharpness due to improved silicone application
- ✔ Improved skin penetration due to optimised cutting edges
- ✔ Fine gradation of needle sizes

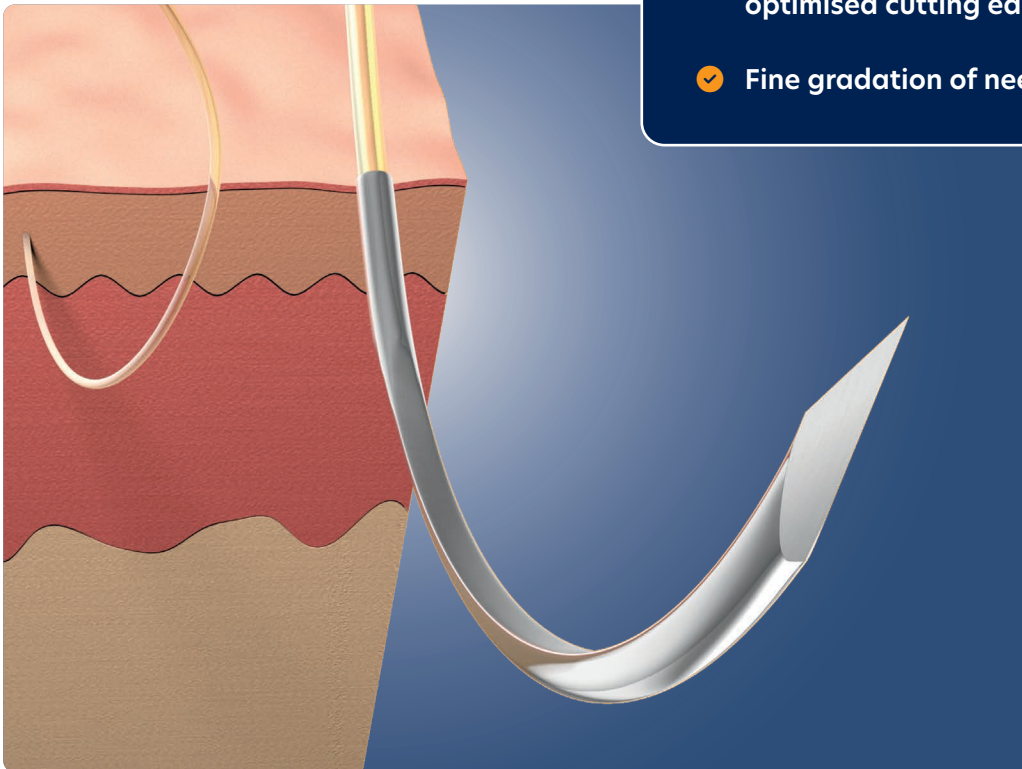

A smooth and effective healing process is vital for delivering excellent functional and aesthetic outcomes after dermatological procedures.

Within our research and development department, first-class handling properties and the highest quality patient outcome, are our top priorities. Modern suture materials have been developed to ensure the best possible support for soft tissue wounds. Needle geometries have been designed specifically for this purpose, ensuring optimal cosmetic results.

GLYCOLON®

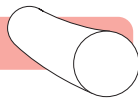

The production of GLYCOLON® involves the copolymerisation of polyglycolic acid and ε-caprolactone in a certain ratio. The breakdown of the polymeric suture in the tissue occurs through water uptake, thereby reversing the synthesis. The strength of GLYCOLON® reduces to 30 % after 7 days. The completely safe intermediary products that are formed, as well as the smooth, monofilament surface structure of the thread, result in minimal tissue reaction. The smooth, monofilament surface structures of the polymer give GLYCOLON® excellent handling and tissue passage properties. Tissue trauma as a result of suturing is not relevant to GLYCOLON®, and the monofilament structure prevents wicking of the thread without the need for additional surface treatment. GLYCOLON® is available undyed, especially suitable for skin closure, and in violet (coloured with the physiologically harmless D+C No. 2 dye).

RESOPREN®



RESOPREN® is a blue, monofilament, synthetic suture made of polyvinylidene difluoride (PVDF). The suture is produced from the dyed granules using the dry spinning process. RESOPREN® is chemically inert, hydrophobic and highly resistant to ageing. Due to its chemical properties, its high tear strength and its good knotting properties, RESOPREN® is particularly suitable for use in non-absorbable intracutaneous sutures. The material is coloured with a physiologically harmless dye.

PGA RESORBA®

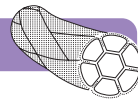

PGA RESORBA® is a polymer of glycolic acid. The linear, high molecular weight polyglycolic acid is synthesised in the presence of a catalyst via the intermediary product glycolide, a cyclic ester. The breakdown of the PGA suture in the tissue occurs through water uptake, thereby reversing the synthesis. Regular metabolic processes break down the glycolic acid monomers into CO₂ and H₂O through enzymatic degradation. The physical and physiological properties of suture material containing 10 % lactide as copolymer differ only slightly from pure PGA sutures.

The thin, precision-braided filaments provide very high tear resistance as well as excellent suppleness. The special coating thinly encapsulates the fibre bundles resulting in a specific reduction of surface friction. Absorbable sutures approximate the tissue during the healing phase; at the same time, they increasingly lose their tensile strength and tear resistance. PGA RESORBA® contains precisionbraided filaments made of polyglycolic acid that result in a standardised, moderate rate of absorption in the tissue. Depending on the thread diameter 50 % of the original tensile strength of PGA RESORBA® is lost after 18 days.* Violet PGA RESORBA® is coloured with a physiologically harmless dye.

RESOLON®



RESOLON® is a monofilament polyamide 6-6.6 suture. It undergoes special treatment during the manufacturing process. RESOLON® is exceptionally soft and supple even when dry and sterile. This ensures excellent handling and knotting properties, combined with optimal knot-pull strength for a monofilament thread, making RESOLON® the preferred choice for percutaneous single interrupted sutures. The material is coloured with a physiologically harmless dye.

PDO RESORBA™

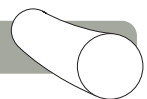

PDO RESORBA™ is made of the polyester poly(p-dioxanone). Because of its slow degradation profile, PDO RESORBA™ is particularly useful where the combination of an absorbable suture and extended wound support (up to six weeks) is desirable. After implantation the breaking load is at 50 - 60 % after 42 days. Absorption by hydrolysis is completed after about 180 to 220 days. Tissue reaction is minimal because of the monofilament structure of the thread. PDO RESORBA™ is supplied violet.

SUPOLENE

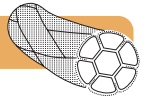

The production of SUPOLENE involves the polycondensation of ethylene glycol and terephthalic acid. Fibres are formed using the dry spinning process. The suture then undergoes precision-braiding, dyeing and tempering and the surface is specially refined by coating. This surface treatment minimises capillarity and any sawing effect during tissue passage and knot rundown. SUPOLENE is hydrophobic, i.e., it does not absorb water. SUPOLENE is particularly suitable when high patient comfort in sensitive areas and/or a particularly high tear resistance are required. The material is coloured with a physiologically harmless dye.

* Articles manufactured by Healthium experience a loss of strength of up to 56 % after 21 days

Peel-eco-Pack:

A combination of peelable outer sachet and multifunctional inner sachet

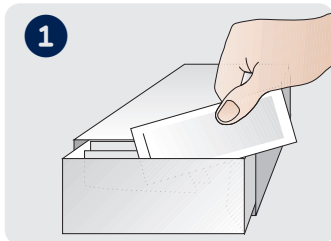

The peel-pack is removed from the storage box.

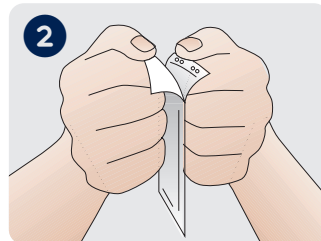

The Circulating Nurse grasps the two opening flaps at the upper end of the pack and opens it by evenly peeling the flaps apart.



The sterile contents are handed over without contamination.

4 Handling of the primary packets:

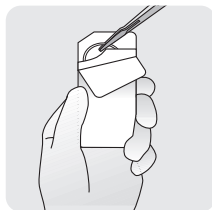

Single pack / needle-thread combination
Precut single sterile sutures with an attached surgical needle. The needle is exposed by turning over the perforated flap. It is then removed with a needle holder.

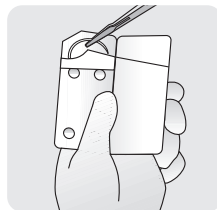

Single pack / needle-thread combination
The needle is exposed by folding out the suture carrier and then withdrawn with the needle holder.

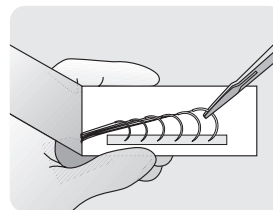

Multipack
Several combinations in each sterile primary packet. This simplifies the organisation of handing over the same thread combinations during standardised procedures. The needles are exposed by opening the side of the paper cover, after which the individual needles (one after the other) are taken out with the needle holder.

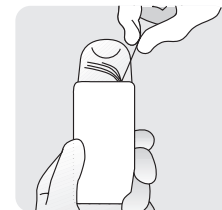

Precut sutures
One or more threads in each sterile primary packet. The suture is meant for ligatures or for use with eyed needles. After the upper flap has been opened, the individual threads can be withdrawn in any desired order.

Instructions

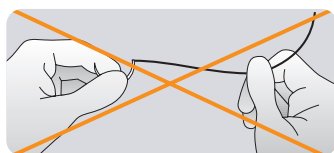

Stretching the thread
The thread must be stretched gently after it has been removed from the primary packet. Do not pull or rub it abruptly. Do not grasp the needle and stretch the thread!

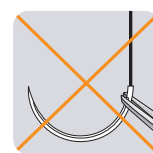
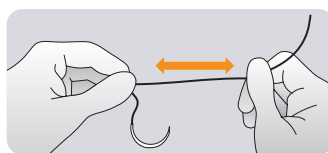

Holding the needle
Needles should be held approx. 3/4 away from the tip. Do not clamp where the suture is swaged to the needle to avoid weakening the needle and suture.

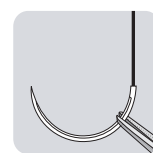

Products	REF	Description	Content
GLYCOLON®			
GLYCOLON® DSM 13	PB41506	Colour: undyed, Thread size: 4-0, monofilament Thread length: 45cm	24 Pc.
GLYCOLON® DSM 13	PB41505	Colour: undyed, Thread size: 5-0, monofilament Thread length: 45cm	24 Pc.
GLYCOLON® DSM 16	PB41510	Colour: undyed, Thread size: 4-0, monofilament Thread length: 45cm	24 Pc.
GLYCOLON® DSM 16	PB41524	Colour: undyed, Thread size: 5-0, monofilament Thread length: 45cm	24 Pc.
GLYCOLON® DSM 18	PB41514	Colour: undyed, Thread size: 3-0, monofilament Thread length: 45cm	24 Pc.
GLYCOLON® DSM 18	PB41526	Colour: undyed, Thread size: 3-0, monofilament Thread length: 70cm	24 Pc.
GLYCOLON® DSM 18	PB41513	Colour: undyed, Thread size: 4-0, monofilament Thread length: 45cm	24 Pc.
GLYCOLON® DSM 18	PB41516	Colour: undyed, Thread size: 5-0, monofilament Thread length: 45cm	24 Pc.
PGA RESORBA®			
PGA RESORBA® DSM 18	PAN1155 ¹⁾	Colour: undyed, Thread size: 3-0, multifilament Thread length: 45cm	24 Pc.
PGA RESORBA® DSM 24	PAN11519 ¹⁾	Colour: undyed, Thread size: 3-0, multifilament Thread length: 45cm	24 Pc.
PGA RESORBA® HRS 12	PA10328	Colour: violet, Thread size: 3-0, multifilament Thread length: 70cm	24 Pc.
PGA RESORBA® HR 17	PAN1025 ¹⁾	Colour: violet, Thread size: 4-0, multifilament Thread length: 70cm	24 Pc.
PDO RESORBA™			
PDO RESORBA™ HR 12	PN2023 ¹⁾	Colour: violet, Thread size: 4-0, monofilament Thread length: 70cm	24 Pc.
PDO RESORBA™ HRS 12	PN2031 ¹⁾	Colour: violet, Thread size: 3-0, monofilament Thread length: 70cm	24 Pc.
PDO RESORBA™ HR 17	PN2028 ¹⁾	Colour: violet, Thread size: 3-0, monofilament Thread length: 70cm	24 Pc.
PDO RESORBA™ HR 17	PN2027 ¹⁾	Colour: violet, Thread size: 4-0, monofilament Thread length: 70cm	24 Pc.
RESOLON®			
RESOLON® DSM 13	881523	Colour: blue, Thread size: 4-0, monofilament Thread length: 45cm	36 Pc.
RESOLON® DSM 13	88154	Colour: blue, Thread size: 5-0, monofilament Thread length: 45cm	36 Pc.
RESOLON® DSM 13	88153	Colour: blue, Thread size: 6-0, monofilament Thread length: 45cm	36 Pc.
RESOLON® DSM 16	88156	Colour: blue, Thread size: 4-0, monofilament Thread length: 45cm	36 Pc.
RESOLON® DSM 16	88155	Colour: blue, Thread size: 5-0, monofilament Thread length: 45cm	36 Pc.
RESOLON® DSM 18	881510	Colour: blue, Thread size: 3-0, monofilament Thread length: 45cm	36 Pc.
RESOLON® DSM 18	881511	Colour: blue, Thread size: 3-0, monofilament Thread length: 75cm	36 Pc.
RESOLON® DSM 18	88158	Colour: blue, Thread size: 4-0, monofilament Thread length: 45cm	36 Pc.
RESOLON® DSM 21	881516	Colour: blue, Thread size: 3-0, monofilament Thread length: 75cm	36 Pc.
RESOPREN®			
RESOPREN® DSM 11	771520	Colour: blue, Thread size: 6-0, monofilament Thread length: 45cm	36 Pc.
RESOPREN® DSM 13	771527	Colour: blue, Thread size: 4-0, monofilament Thread length: 45cm	36 Pc.
RESOPREN® DSM 13	771517	Colour: blue, Thread size: 5-0, monofilament Thread length: 45cm	36 Pc.
RESOPREN® DSM 13	771526	Colour: blue, Thread size: 6-0, monofilament Thread length: 45cm	36 Pc.
RESOPREN® DSM 16	77151	Colour: blue, Thread size: 4-0, monofilament Thread length: 45cm	36 Pc.
RESOPREN® DSM 16	771525	Colour: blue, Thread size: 5-0, monofilament Thread length: 45cm	36 Pc.
RESOPREN® DSM 18	77154	Colour: blue, Thread size: 3-0, monofilament Thread length: 45cm	36 Pc.
RESOPREN® DSM 18	77155	Colour: blue, Thread size: 3-0, monofilament Thread length: 75cm	36 Pc.
RESOPREN® DSM 18	77153	Colour: blue, Thread size: 4-0, monofilament Thread length: 45cm	36 Pc.
RESOPREN® DSM 21	771524	Colour: blue, Thread size: 3-0, monofilament Thread length: 75cm	36 Pc.
SUPOLENE			
SUPOLENE DSM 13	9152	Colour: green, Thread size: 5-0, multifilament Thread length: 45cm	36 Pc.
SUPOLENE DSM 16	9156	Colour: green, Thread size: 4-0, multifilament Thread length: 45cm	36 Pc.
SUPOLENE DSM 16	9155	Colour: green, Thread size: 5-0, multifilament Thread length: 45cm	36 Pc.
SUPOLENE DSM 18	9158	Colour: green, Thread size: 3-0, multifilament Thread length: 45cm	36 Pc.
SUPOLENE DSM 18	9157	Colour: green, Thread size: 4-0, multifilament Thread length: 45cm	36 Pc.

¹⁾ Product manufactured by:

Healthium Medtech Limited · #472-D, 13th Cross, 4th Phase
 Peenya Industrial Area, Bangalore, Karnataka-560058, India
 Email: care@healthiummedtech.com
 Mfg. Lic. No.: MFG/MD/2021/000367





RESORBA Medical GmbH

Am Flachmoor 16, 90475 Nürnberg, Germany

🖱 resorba.com | ✉ infomail@resorba.com | ☎ +49 9128 / 91 15 0



Advanced Medical Solutions